

**PHONIC**

# TRUE DIVERSITY WIRELESS MICROPHONE & INSTRUMENT SYSTEMS

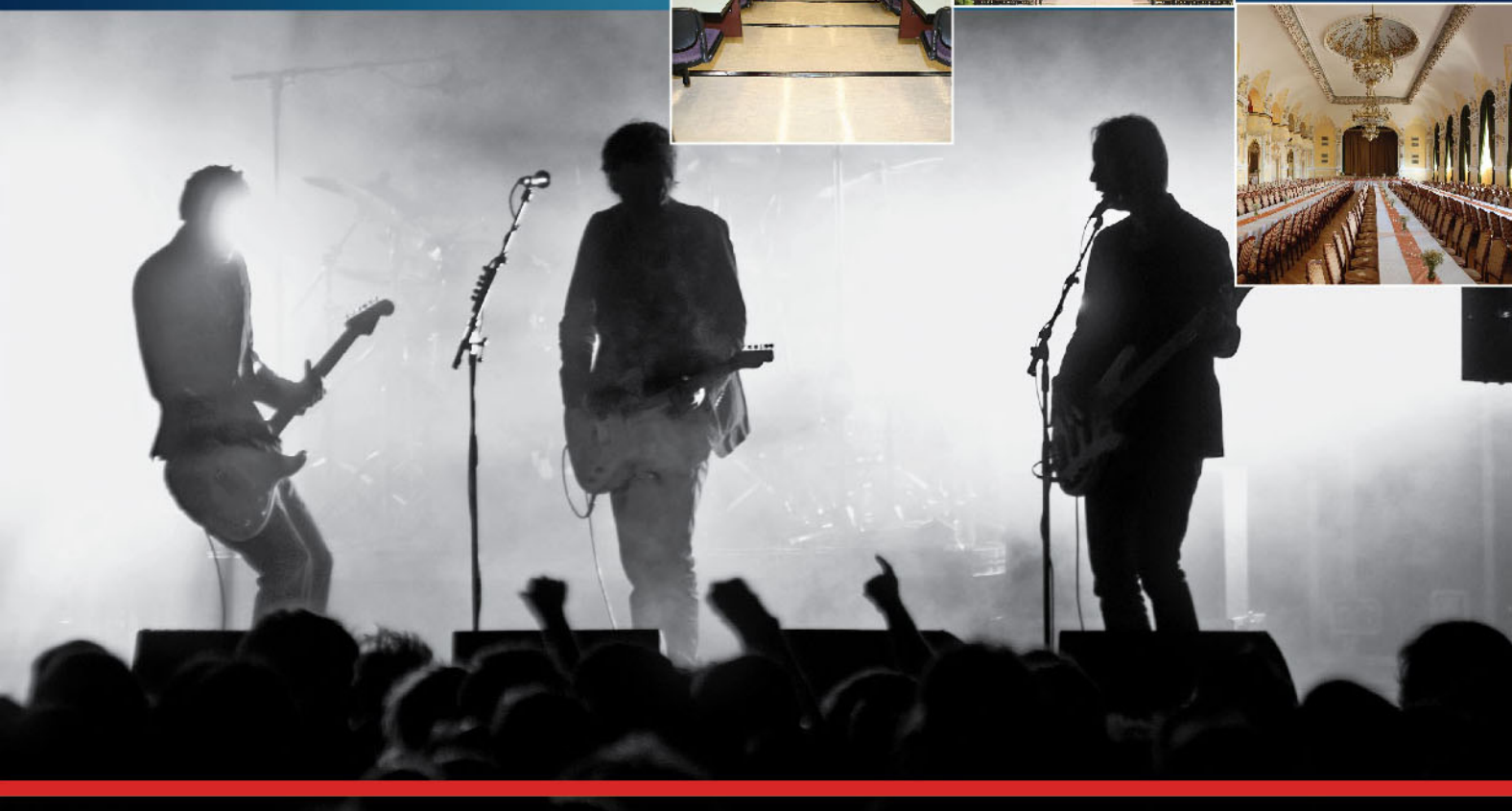





The Phonic PR, PCT, WG and WI series of single and dual channel wireless microphone and instrument systems are the culmination of years of experience in both wired and wireless technologies. Take the headache out of your live setups by incorporating one of these fantastically simple wireless systems. Utilizing UHF for maximum range and PLL-synthesized technology for RF stability, the Phonic wireless systems allow you to unleash your live performances like never before. Simple to setup with flawless operation each and every time, go wireless with Phonic today!

- Front panel RF and AF metering for system and performance monitoring
- Compact half-rack design for discrete installation and operation
- Flexible noise squelch technology for clear, noise-free performances every time
- Front panel sensitivity controls for adjusting incoming mic signals
- Stable performance even when using multiple units or channels
- Rear-panel +10, 0, -6 dB switch for contouring level to input devices
- Detachable diversity antennas for flexible setup and installation
- Perfect for Karaoke (KTV) bars, small bands, churches and other live stage performances

**UHF**

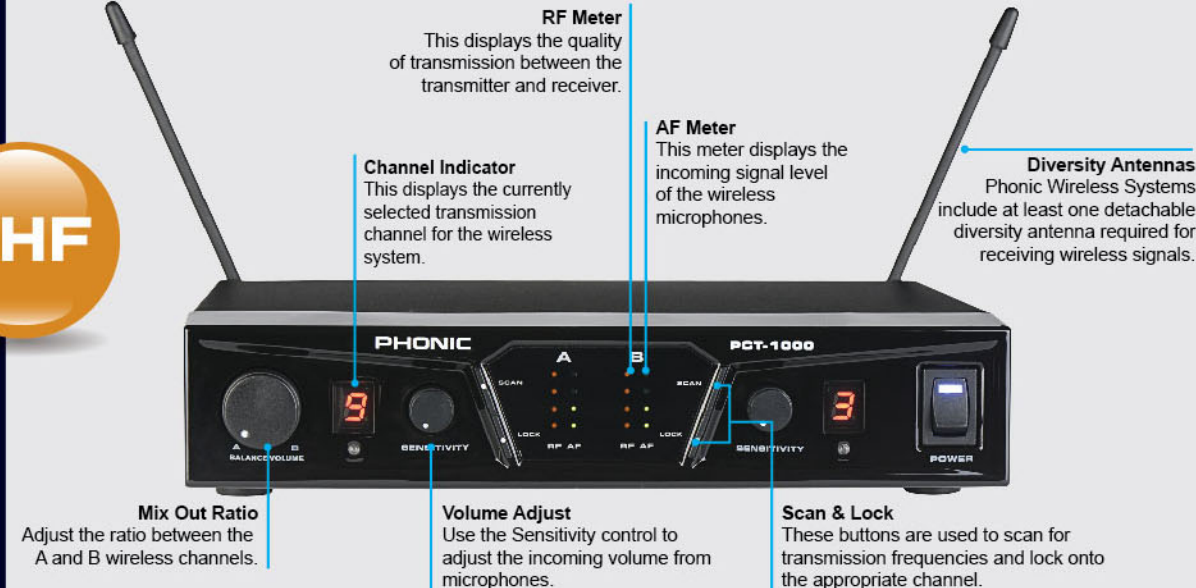

#### OPTIONAL:



PCT-3000 receiver is Phonic's flexible wideband diversity wireless microphone system. With two receiver channels, each with 29 presets and 1 user-defined channel groups, these can operate in any venue without interference or noise. Phonic's popular one-touch auto-scan technology allows the transmitter and receiver to be linked within seconds for optimal performance.

#### PCT-3000

Professional wideband true diversity wireless receiver

- 29-Preset +1 User Defined channel groups with 16 channels per group (480 channels total)
- Up to 10 channels can be used per channel group for a maximum of 48 microphones in a single venue
- 1/4" phone jack and XLR outputs for balanced or unbalanced signals
- Clear display offers frequency information for ultimate control over system
- Advanced diversity circuitry helps to improve stability and avoid dropouts
- Run up to 24 units / 48 channels interference-free in a single venue
- Effective range up to 70 meters / 230 feet



The PCT-1000 offers flexible one-touch setup, allowing transmitter and receiver units to be linked up in a matter of seconds. With 16 preset channels, the PCT-1000 can provide flawless performance in even the harshest of conditions.

#### PCT-1000 (WM-1 x2)

Dual-channel wireless receiver with two handheld wireless microphones

- Auto-Scan technology automatically seeks and uses the best frequency
- 1/4" phone jack and XLR outputs for balanced or unbalanced signals
- Volume balance control adjusts level balance between A and B channels
- Advanced diversity circuitry helps to improve stability and avoid dropouts
- Run up to 6 units / 12 channels interference-free in a single venue
- Effective range up to 70 meters / 230 feet

#### PCT-1000B (WL-1 x2)

Dual-channel receiver & 2 bodypack transmitters + 2 lavalier microphones



The PR-900 offers two wireless microphone channels with a plug-and-play design. After an initial setup, the PR-900 will work flawlessly with wireless microphones with little-to-no setup required on the part of the user.

#### PR-900 (WM-1 x2)

Dual-channel wireless receiver with two handheld wireless microphones

- Simple plug-and-play design for immediate and easy operation
- 1/4" phone jack outputs for balanced or unbalanced signals
- Volume balance control adjusts level balance between A and B channels
- Advanced diversity circuitry helps to improve stability and avoid dropouts
- Run up to 4 units / 8 channels interference-free in a single venue
- Effective range up to 60 meters / 200 feet

#### PR-900B (WL-1 x2)

Dual-channel receiver & 2 bodypack transmitters + 2 lavalier microphones



If the idea of scanning and linking transmission channels seems a little over-whelming, Phonic presents the PR-800 to the user who demands simplicity. PR-800's plug-and-play design automatically links and operates with wireless microphones each time you use it.

#### PR-800 (WM-1 x1)

Single-channel wireless receiver with a single handheld wireless microphone

- Simple plug-and-play design for immediate and easy operation
- Single channel operation for use with one wireless transmitter system
- 1/4" phone jack output for balanced or unbalanced signals
- Advanced diversity circuitry helps to improve stability and avoid dropouts
- Run up to 6 units interference-free in a single venue
- Effective range up to 60 meters / 200 feet

#### PR-800B (WL-1 x1)

Single-channel receiver & 1 bodypack transmitter + 1 lavalier microphones



The WG-800 wireless guitar system features a simple, battery-powered transmitter that inserts simply into any guitar's 1/4" output connector. Utilizing the same technology as the PR-800, no complicated setup is required on the part of the user!

#### WG-800 (WG-1 x1)

Wireless Receiver with Guitar Transmitter

- Simple plug-and-play design for immediate and easy operation
- 1/4" phone jack outputs for balanced or unbalanced signals
- Advanced diversity circuitry helps to improve stability and avoid dropouts
- Perfect for use with any guitar featuring 1/4" output
- Run up to 6 units interference-free in a single venue
- Effective range up to 60 meters / 200 feet



The WI-800 wireless instrument system features a flexible clip-on instrument pick-up that can be attached to most wind and brass instruments. This connects to a discrete bodypack transmitter that can be clipped to your belt. These units utilize the same technology as the PR-800 receiver for simple plug-and-play operation.

#### WI-800 (WI-1 x1)

Wireless Receiver with Brass Instrument Pickup

- Simple plug-and-play design for immediate and easy operation
- 1/4" phone jack outputs for balanced or unbalanced signals
- Advanced diversity circuitry helps to improve stability and avoid dropouts
- Versatile pickup with bodypack idea for use with brass and wind instruments
- Run up to 6 units interference-free in a single venue
- Effective range up to 60 meters / 200 feet



## Specifications

**WG 800**



**PR 800  
WI 800**

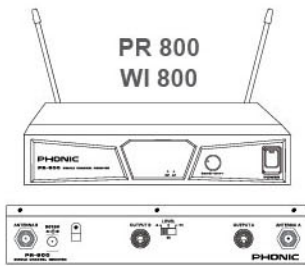

**PR 900**

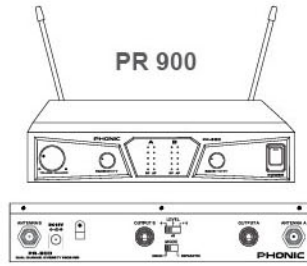

**PCT-1000**

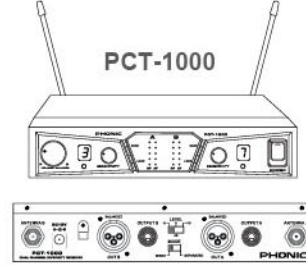

**PCT-3000**

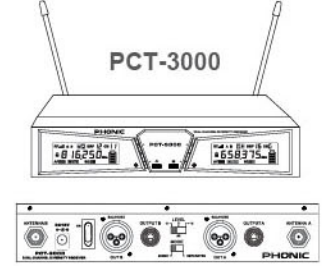

Preprogrammed  
Frequencies

Single Channel Fixed  
Frequency

Dual Channel Fixed  
Frequency

16-Preset Frequency Channels  
w/ Autoscans Technology

29-Preset +1 User Defined  
Channel Groups w/ Autoscans  
Technology

Carrier Frequency Range

500 to 875MHz  
(region dependent)

500 to 875MHz  
(region dependent)

500 to 875MHz  
(region dependent)

500 to 875MHz  
(region dependent)

Deviation

±56KHz, with level limiting

±56KHz, with level limiting

±50KHz, with level limiting

±50KHz, with level limiting

Max. Simultaneous Units

Up to 6 units (6 mics)

Up to 4 units (8 mics)

Up to 6 units (12 mics)

10 channels per group (48 mics total)

Operating Distance

Up to 60 meters / 200 feet

Up to 60 meters / 200 feet

Up to 70 meters / 230 feet

Up to 70 meters / 230 feet

Bandwidth

24 MHz

24 MHz

24 MHz

72 MHz

Stability

±0.005%

±0.005%

±0.005%

±0.005%

S/N Ratio

>106dB (A-weighted)

>106dB (A-weighted)

>106dB (A-weighted)

>106dB (A-weighted)

T.H.D.

<0.5% @ 1 kHz

<0.5% @ 1 kHz

<0.5% @ 1 kHz

<0.5% @ 1 kHz

Frequency Response

50Hz to 18KHz

50Hz to 18KHz

50Hz to 18KHz

50Hz to 18KHz

Sensitivity

S/N>76dB at 10 micro V

S/N>76dB at 10 micro V

S/N>76dB at 10 micro V

S/N>76dB at 10 micro V

Spurious Rejection

> 80dB

> 80dB

> 80dB

> 80dB

Output Connectors

¼" TRS

¼" TRS (per channel)

¼" TRS and XLR (per channel)

¼" TRS and XLR (per channel)

Output Level Switch

Selectable: +10dBV,  
0dBV, -6dBV

Selectable: +10dBV,  
0dBV, -6dBV

Selectable: +10dBV,  
0dBV, -6dBV

Selectable: +10dBV,  
0dBV, -6dBV

Power Supply

DC 15V, 0.6A

DC 15V, 0.6A

DC 15V, 0.8A

DC 15V, 0.8A

Dimensions (W x D x H)

218 × 192 × 44 mm  
(8.6" 7.6" x 1.7")

218 × 192 × 44 mm  
(8.6" 7.6" x 1.7")

218 × 192 × 44 mm  
(8.6" 7.6" x 1.7")

218 × 192 × 44 mm  
(8.6" 7.6" x 1.7")

Weight

1.2 kg (2.6 lbs)

1.7 kg (3.75 lbs)

1.8 kg (3.97 lbs)

1.8 kg (3.97 lbs)

## Accessories

**WM-1** Single UHF  
Handheld Microphone



**WL-1** Single Lavalier  
Microphone with UHF  
Bodypack Transmitter



**WH-1** Single Headset  
Microphone with UHF  
Bodypack Transmitter



**WG-1** Single UHF Guitar  
Instrument Wireless  
Transmitter



**WI-1** Single Brass/Instrument  
Pickup with UHF Bodypack  
Transmitter



**PR-RK1** Rack-mounting Kit  
(compatible with PR-800, PR-900,  
PCT-1000)

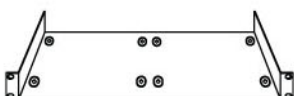

**WM-X** Single UHF Handheld  
Microphone with LCD (PCT-3000  
compatible)



**WL-X** Single Lavalier Microphone  
with Bodypack Transmitter  
(PCT-3000 compatible)



**WH-X** Single Headset Microphone  
with UHF Bodypack Transmitter  
(PCT-3000 compatible)

