

PHONIC

TRUE DIVERSITY WIRELESS MICROPHONE & INSTRUMENT SYSTEMS

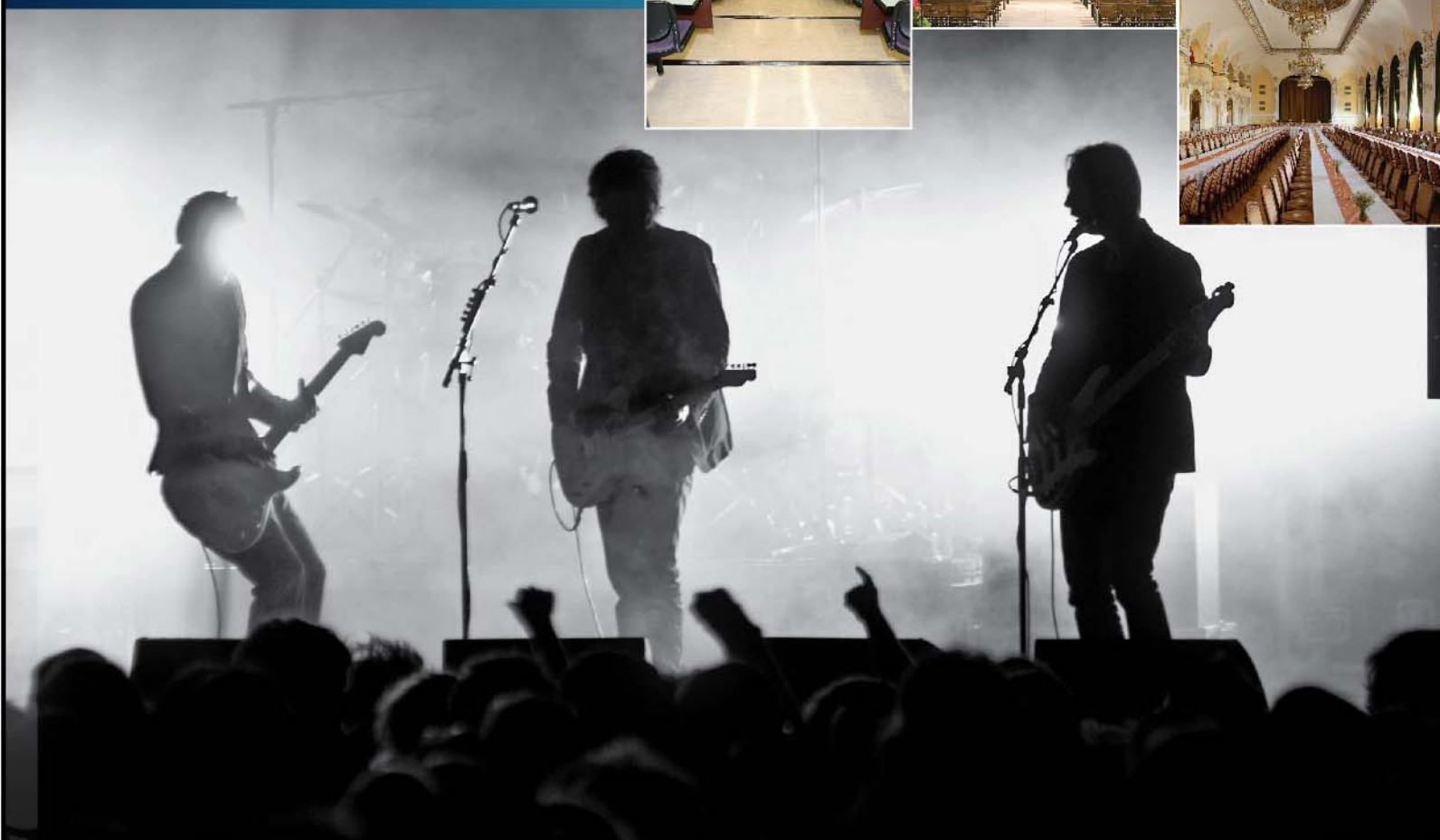



The Phonic PR, PCT, WG and WI series of single and dual channel wireless microphone and instrument systems are the culmination of years of experience in both wired and wireless technologies. Take the headache out of your live setups by incorporating one of these fantastically simple wireless systems. Utilizing UHF for maximum range and PLL-synthesized technology for RF stability, the Phonic wireless systems allow you to unleash your live performances like never before. Simple to setup with flawless operation each and every time, go wireless with Phonic today!

- Front panel RF and AF metering for system and performance monitoring
- Compact half-rack design for discrete installation and operation
- Flexible noise squelch technology for clear, noise-free performances every time
- Front panel sensitivity controls for adjusting incoming mic signals
- Stable performance even when using multiple units or channels
- Rear-panel +10, 0, -6 dB switch for contouring level to input devices
- Detachable diversity antennas for flexible setup and installation
- Perfect for Karaoke (KTV) bars, small bands, churches and other live stage performances

UHF

PCT-3000

PCT-3000 receiver is Phonic's flexible wideband diversity wireless microphone system. With two receiver channels, each with 29 presets and 1 user-defined channel groups, these can operate in any venue without interference or noise. Phonic's popular one-touch auto-scan technology allows the transmitter and receiver to be linked within seconds for optimal performance.

PCT-3000M

With the WM-X handheld microphones delivering on reliability, durability and flexibility, the Phonic PCT-3000M dual channel wireless microphone systems allow users to search over 29 preset channel groups and set up a single user-definable group, with 416 independent usable channels, allowing for the cleanest transmission possible. Up to 48 microphones can be used at one time in a single venue (dependent on venue conditions) while a maximum of 10 channels can be used in each channel group. The PCT-3000M receiver provides an ultra-wide bandwidth of 72MHz that provides flawless operation, while.



- Run up to 48 microphones interference-free in a single venue, maximum 10 channels per group at a time
- 29 preset channel groups plus one user-defined group, 16 channels per group (416 channels total)
- Clear display offers frequency information for ultimate control over transmission
- Rapid auto-scan syncing with transmitters for easy, immediate operation
- Balanced and unbalanced output through XLR and 1/4" TRS phone jacks
- Advanced diversity circuitry helps to improve stability and avoid dropouts

- Broad channel range makes multiple systems ideal for use at any one time
- Rear-panel +10, 0, -6 dB switch for contouring level to input devices
- Stable performance even in the event that multiple units or channels are used
- Flexible noise squelch technology for clear, noise-free performances every time
- Detachable diversity antennas for flexible setup and installation
- Transmitters feature LCD screens with battery and frequency monitoring/control
- Perfect for Karaoke (KTV) bars and live stage performances
- Two WM-X Handheld Microphone with LCD included

Optional Accessories



WM-X
Wideband Handheld
microphone with LCD
display



WL-X
Wideband bodypack
transmitter with LCD
display with Lavalier
microphone



WH-X
Wideband bodypack
transmitter with LCD
display with Headset
microphone

PCT1000M

Containing one Phonic's PCT1000 Dual-Channel Wireless Microphone Receiver and two WM-1 handheld microphones, PCT1000M Dual-Channel Handheld Wireless Microphone System is the best solution for presentation applications such as demonstration, lecture, speech, worship or live drama where two presenters or lecturers are required. The PCT-1000 offers flexible one-touch setup, allowing transmitter and receiver units to be linked up in a matter of seconds. With 16 preset channels, the PCT-1000 can provide flawless performance in even the harshest of conditions.



PCT1000L

Containing one Phonic's PCT1000 Dual-Channel Wireless Microphone Receiver and two WL-1 lavalier microphones, PR-1000L Dual-Channel Lavalier Wireless Microphone System is the best solution for presentation applications such as demonstration, lecture, speech, worship or live drama where two presenters or performers are required and the "hidden microphone" is essential. The PCT-1000 offers flexible one-touch setup, allowing transmitter and receiver units to be linked up in a matter of seconds. With 16 preset channels, the PCT-1000 can provide flawless performance in even the harshest of conditions.

PCT1000H

Containing one Phonic's PCT1000 Dual-Channel Wireless Microphone Receiver and two WH-1 headset microphones, PR-1000H Dual-Channel Headset Wireless Microphone System is the best solution for presentation applications such as demonstration, lecture, speech and worship where two presenters or performers are required. The PCT-1000 offers flexible one-touch setup, allowing transmitter and receiver units to be linked up in a matter of seconds. With 16 preset channels, the PCT-1000 can provide flawless performance in even the harshest of conditions.

- Simple plug-and-play design for immediate and easy operation
- Two Channel number displays
- Dual channel operation for use with one wireless transmitter system
- Two Balanced 1/4" TRS and two XLR output jacks
- Advanced diversity circuitry helps to improve stability and avoid dropouts
- Front panel RF and AF metering for system and performance monitoring

- Front panel sensitivity controls for adjusting incoming mic signals
- Rear-panel +10, 0, -6 dB switch for contouring level to input devices
- Run up to 12 units interference-free in a single venue
- Effective range up to 60 meters/200 feet
- Auto-Scan Frequency function establishes the connection between the transmitter and the receiver in a snap of fingers

PR900M

Containing one Phonic's PR900 Dual-Channel Wireless Microphone Receiver and two WM-1 handheld microphones, PR-900M Dual-Channel Handheld Wireless Microphone System is the best solution for presentation applications such as demonstration, lecture, speech, worship or live drama where two presenters or lecturers are required. With the built-in selectable 16 present frequency mechanism, it is allowed to operate up to 12 PR-900M (24 performers/lecturers) simultaneously (location dependent). And regarding interference prevention, PR900 adopts PLL (Phase-locked loops) synchronization, auto mute and other advanced technologies and features a LEVEL switch (-6/0/+10), MODE switch (separated/mixed), channel-independent RF/AF indicators, SENSITIVITY knobs and Volume/Balance knob to offer a intuitional worry-free and plug-n'-play user experience and make every presentation and show perfect.



PR900L

Containing one Phonic's PR900 Dual-Channel Wireless Microphone Receiver and two WL-1 lavalier microphones, PR-900L Dual-Channel Lavalier Wireless Microphone System is the best solution for presentation applications such as demonstration, lecture, speech, worship or live drama where two presenters or performers are required and the "hidden microphone" is essential. With the built-in selectable 16 present frequency mechanism, it is allowed to operate up to 12 PR-900L (24 performers/lecturers) simultaneously (location dependent). And regarding interference prevention, PR900 adopts PLL (Phase-locked loops) synchronization, auto mute and other advanced technologies and features a LEVEL switch (-6/0/+10), MODE switch (separated/mixed), channel-independent RF/AF indicators, SENSITIVITY knobs and Volume/Balance knob to offer a intuitional worry-free and plug-n'-play user experience and make every presentation and show perfect.

PR900H

Containing one Phonic's PR900 Dual-Channel Wireless Microphone Receiver and two WH-1 headset microphones, PR-900H Dual-Channel Headset Wireless Microphone System is the best solution for presentation applications such as demonstration, lecture, speech and worship where two presenters or performers are required. With the built-in selectable 16 present frequency mechanism, it is allowed to operate up to 12 PR-900H (24 performers) simultaneously (location dependent). And regarding interference prevention, PR900 adopts PLL (Phase-locked loops) synchronization, auto mute and other advanced technologies and features a LEVEL switch (-6/0/+10), MODE switch (separated/mixed), channel-independent RF/AF indicators, SENSITIVITY knobs and Volume/Balance knob to offer a intuitional worry-free and plug-n'-play user experience and make every presentation and show perfect.

- Simple plug-and-play design for immediate and easy operation
- Balanced/unbalanced 1/4" TRS output jack
- Advanced diversity circuitry helps to improve stability and avoid dropouts
- Front panel RF and AF metering for system and performance monitoring
- Front panel sensitivity controls for adjusting incoming mic signals

- Rear-panel +10, 0, -6 dB switch for contouring level to input devices
- Run up to 12 units interference-free in a single venue
- Effective range up to 60 meters/200 feet
- Auto-Scan Frequency function establishes the connection between the transmitter and the receiver in a snap of fingers

PR800M

Containing one Phonic's PR800 Single-Channel Wireless Microphone Receiver and one WM-1 handheld microphones, PR-800M Single-Channel Handheld Wireless Microphone System is the best solution for presentation applications such as demonstration, lecture, speech or worship. PR800 wireless receiver adopts PLL (Phase-locked loops) synchronization, auto mute and other advanced technologies and features a LEVEL switch (-6/0/+10), RF/AF indicators and SENSITIVITY knobs to offer a intuitional worry-free and plug-n'-play user experience and make every performance excellent and perfect.



PR800L

Designed uniquely to "liberate" active performers and presenters, and offering one Phonic's PR800 Single-Channel Wireless Microphone Receiver and one WL-1 Lavalier microphones, PR800L Single-Channel Lavalier Wireless Microphone System is the best solution for presentation applications such as demonstration, lecture, speech and worship. PR800 wireless receiver adopts PLL (Phase-locked loops) synchronization, auto mute and other advanced technologies and features a LEVEL switch (-6/0/+10), RF/AF indicators and SENSITIVITY knobs to offer a intuitional worry-free and plug-n'-play user experience and make every performance excellent and perfect.

PR800H

Designed uniquely to "liberate" active performers and presenters, and offering one Phonic's PR800 Single-Channel Wireless Microphone Receiver and one WH-1 headset microphones, PR800H Single-Channel Headset Wireless Microphone System is the best solution for presentation applications such as demonstration, lecture, speech and worship. PR800 wireless receiver adopts PLL (Phase-locked loops) synchronization, auto mute and other advanced technologies and features a LEVEL switch (-6/0/+10), RF/AF indicators and SENSITIVITY knobs to offer a intuitional worry-free and plug-n'-play user experience and make every performance excellent and perfect.

- Simple plug-and-play design for immediate and easy operation
- One unbalanced 1/4" TS output jack
- Advanced diversity circuitry helps to improve stability and avoid dropouts
- Front panel RF and AF metering for system and performance monitoring
- Front panel sensitivity controls for adjusting incoming mic signals

- Broad channel range makes multiple systems ideal for use at any one time
- Rear-panel +10, 0, -6 dB switch for contouring level to input devices
- Flexible noise squelch technology for clear, noise-free performances every time
- Auto-Scan Frequency function establishes the connection between the transmitter and the receiver in a snap of fingers

PR750M

Containing one Phonic's PR750 Dual-Channel Wireless Microphone Receiver and two WM-2 handheld microphones, PR-750M Dual-Channel Handheld Wireless Microphone System is the best solution for presentation applications such as demonstration, lecture, speech, worship or live drama where two presenters or lecturers are required. With the built-in selectable 16 present frequency mechanism, it is allowed to operate up to 12 PR-750M (24 performers/lecturers) simultaneously (location dependent). And regarding interference prevention, PR750 adopts PLL (Phase-locked loops) synchronization, auto mute and other advanced technologies and features a LEVEL switch (-6/0/+10), MODE switch (separated/mixed), channel-independent RF/AF indicators and SENSITIVITY knobs to offer a intuitional worry-free and plug-n'-play user experience and make every presentation and show perfect.



PR750L

Containing one Phonic's PR750 Dual-Channel Wireless Microphone Receiver, two belpack transmitters and two WL-2 lavalier microphones, PR-750L Dual-Channel Lavalier Wireless Microphone System is the best solution for presentation applications such as demonstration, lecture, speech, worship or live drama where two presenters or performers are required and the "hidden microphone" is essential. With the built-in selectable 16 present frequency mechanism, it is allowed to operate up to 12 PR-750L (24 performers/lecturers) simultaneously (location dependent). And regarding interference prevention, PR750 adopts PLL (Phase-locked loops) synchronization, auto mute and other advanced technologies and features a LEVEL switch (-6/0/+10), MODE switch (separated/mixed), channel-independent RF/AF indicators and SENSITIVITY knobs to offer a intuitional worry-free and plug-n'-play user experience and make every presentation and show perfect.

PR750H

Containing one Phonic's PR750 Dual-Channel Wireless Microphone Receiver, and two WH-2 headset microphones, PR-750H Dual-Channel Headset Wireless Microphone System is the best solution for presentation applications such as demonstration, lecture, speech and worship where two presenters or performers are required. With the built-in selectable 16 present frequency mechanism, it is allowed to operate up to 12 PR-750H (24 performers) simultaneously (location dependent). And regarding interference prevention, PR750 adopts PLL (Phase-locked loops) synchronization, auto mute and other advanced technologies and features a LEVEL switch (-6/0/+10), MODE switch (separated/mixed), channel-independent RF/AF indicators and SENSITIVITY knobs to offer a intuitional worry-free and plug-n'-play user experience and make every presentation and show perfect.

- Simple plug-and-play design for immediate and easy operation
- Dual channel operation for use with one wireless transmitter system
- Balanced/unbalanced 1/4" TRS output jack
- Advanced diversity circuitry helps to improve stability and avoid dropouts
- Front panel RF and AF metering for system and performance monitoring

- Front panel sensitivity controls for adjusting incoming mic signals
- Rear-panel +10, 0, -6 dB switch for contouring level to input devices
- Run up to 12 units interference-free in a single venue
- Effective range up to 60 meters/200 feet

PR700M

Containing one Phonic's PR700 Single-Channel Wireless Microphone Receiver and one WM-2 handheld microphones, PR-700M Single-Channel Handheld Wireless Microphone System is the best solution for presentation applications such as demonstration, lecture, speech or worship. With the built-in selectable 16 present frequency mechanism, it is allowed to operate up to 12 PR-700M simultaneously (location dependent). And regarding interference prevention, PR700 adopts PLL (Phase-locked loops) synchronization, auto mute and other advanced technologies and features a LEVEL switch (-6/0/+10), MODE switch (separated/mixed), channel-independent RF/AF indicators and SENSITIVITY knobs to offer a intuitional worry-free and plug-n'-play user experience and make every presentation and show perfect.



PR700L

Containing one Phonic's PR700 Single-Channel Wireless Microphone Receiver, one belt-pack transmitters and one WL-2 lavalier microphones, PR-700L Single-Channel Lavalier Wireless Microphone System is the best solution for presentation applications such as demonstration, lecture, speech, worship or live drama where the "hidden microphone" is essential. With the built-in selectable 16 present frequency mechanism, it is allowed to operate up to 12 PR-700L (12 performers/lecturers) simultaneously (location dependent). And regarding interference prevention, PR700 adopts PLL (Phase-locked loops) synchronization, auto mute and other advanced technologies and features a LEVEL switch (-6/0/+10), MODE switch (separated/mixed), channel-independent RF/AF indicators and SENSITIVITY knobs to offer a intuitional worry-free and plug-n'-play user experience and make every presentation and show perfect..

PR700H

Containing one Phonic's PR700 Single-Channel Wireless Microphone Receiver, one WB-1 belt-pack transmitters and one WH-1 headset microphones, PR-700H Single-Channel Headset Wireless Microphone System is the best solution for presentation applications such as demonstration, lecture, speech and worship. With the built-in selectable 16 present frequency mechanism, it is allowed to operate up to 12 PR-700H simultaneously (location dependent). And regarding interference prevention, PR700 adopts PLL (Phase-locked loops) synchronization, auto mute and other advanced technologies and features a LEVEL switch (-6/0/+10), MODE switch (separated/mixed), channel-independent RF/AF indicators and SENSITIVITY knobs to offer a intuitional worry-free and plug-n'-play user experience and make every presentation and show perfect.

- Simple plug-and-play design for immediate and easy operation
- Balanced/unbalanced 1/4" TRS output jack
- Advanced diversity circuitry helps to improve stability and avoid dropouts
- Front panel RF and AF metering for system and performance monitoring

- Front panel sensitivity controls for adjusting incoming mic signals
- Rear-panel +10, 0, -6 dB switch for contouring level to input devices
- Run up to 12 units interference-free in a single venue
- Effective range up to 60 meters/200 feet

WG800

Phonic's WG800 Wireless GT system is designed and developed uniquely for guitarists, bassists and other instrumentalists. Adopting PLL (Phase-locked loops) synchronization and true diversity technologies, and operating in 24 MHz, isolated from TV and DTV interference, WG800 Wireless GT system combines 16 present frequency mechanism, 1/4" (6.35mm) TS connector, RF/AF indicators and volume knobs to offer a intuitional worry-free and plug-n'-play user experience and make every performance excellent and truly "alive and kicking". and the receiver is able to be paired with up to 10 transmitters, offering real-time instruments switching without moving and changing body-pack. WG800 Wireless GT system features "remote frequency setting", through which the transmitter and the receiver can get linked in the snap of fingers. With the shipped 3.5mm/6.35mm TS connector adapter, WG800 Wireless GT system can be also work as an wireless system for consumer audio playback devices.



- Simple plug-and-play design for immediate and easy operation
- One unbalanced 1/4" TS output jack
- Advanced diversity circuitry helps to improve stability and avoid dropouts
- Front panel RF and AF metering for system and performance monitoring

- Front panel volume controls for adjusting incoming signals
- Broad channel range makes multiple systems ideal for use at any one time
- Flexible noise squelch technology for clear, noise-free performances every time
- 3.5mm/6.35mm TS connector adapter included

WI800

WI800 adopts PLL (Phase-locked loops) synchronization, auto mute and other advanced technologies and features a LEVEL switch (-6/0/+10), RF/AF indicators and SENSITIVITY knobs to offer a intuitional worry-free and plug-n'-play user experience and make every performance excellent and perfect. Furthermore, the Auto-Scan Frequency function allows the connection between the transmitter and the receiver is established via the 16 preset frequencies, just button pressing is required, in a snap of fingers. The included battery-powered (2 AA batteries) belt-pack transmitters features a MUTE button, offering the maximum stage management quality and flexibility during the event. And the microphone delivers excellent sound quality for applications where the microphone is required be virtually invisible, such as acoustic music instrument like acoustic guitar, violin, saxophone or percussion...etc.



- Simple plug-and-play design for immediate and easy operation
- Single channel operation for use with one wireless transmitter system
- One unbalanced 1/4" TS output jack
- Advanced diversity circuitry helps to improve stability and avoid dropouts
- Front panel RF and AF metering for system and performance monitoring
- Front panel sensitivity controls for adjusting incoming mic signals

- Broad channel range makes multiple systems ideal for use at any one time
- Rear-panel +10, 0, -6 dB switch for contouring level to input devices
- Flexible noise squelch technology for clear, noise-free performances every time
- Auto-Scan Frequency function establishes the connection between the transmitter and the receiver in a snap of fingers

Tour Guide System

PTG-16TH +Headset microphone (Transmitter)

PTG-16TH Wireless Tour Guide Transmitter adopts PLL (Phase-locked loops) synchronization and other advanced technologies to offer the excellent and stable audio transmission quality. PTG-16TH features large orange LCD offering information such as channel number, RF/AF status and battery status, to allow user access operation status in real time. Via the two channel scan buttons, PTG-16TH can establish the connection with receivers via the 16 preset frequencies, just button pressing is required, in a snap of fingers.



PTG-16T

PTG-16R

- 16 preset frequencies
- PLL (Phase-locked loops) synchronization
- Large amber LCD
- 3.5 mm Headset input jack

PTG-16R (Receiver)

Designed and developed uniquely for offering the real solution for the application of tour guiding, PTG-16R Wireless Tour Guide Receiver adopts PLL (Phase-locked loops) synchronization and other advanced technologies to offer the excellent and stable audio transmission quality. PTG-16R features large amber LCD offering information such as channel number, RF/Volume status and battery status, to allow user access operation status in real time. The last but not the least, PTG-16R features onboard microphone that allows to make communication with the PTG-16T, making your tour guiding more interactive.



- 16 preset frequencies
- PLL (Phase-locked loops) synchronization
- Large amber LCD
- 3.5 mm output phone jack
- Onboard microphone

Optional Accessories



WM-1

PR 800M | PR 9000M | PCT1000M

Single UHF handheld autoscans microphone (2 AA Battery)



WL-1

PR 800L | PR 9000L | PCT1000L

Single UHF Lavalier microphone with autoscans body pack transmitter (2 AA Battery)



WH-1

PR 800H | PR 9000H | PCT1000H

Single UHF Headset microphone with autoscans body pack transmitter (2 AA Battery)

PR-RK1 Rack-mounting Kit (compatible with PR-800, PR-900, PCT-1000)

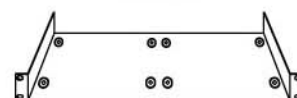

WM-2

PR 700M | PR 750M

Single UHF handheld preset microphone (2 AA Battery)



WL-2

PR 700L | PR 750L

Single UHF lavalier microphone with preset body pack transmitter (2 AA Battery)



WH-2

PR 700H | PR 750H

Single UHF headset microphone with preset body pack transmitter (2 AA Battery)

Specifications

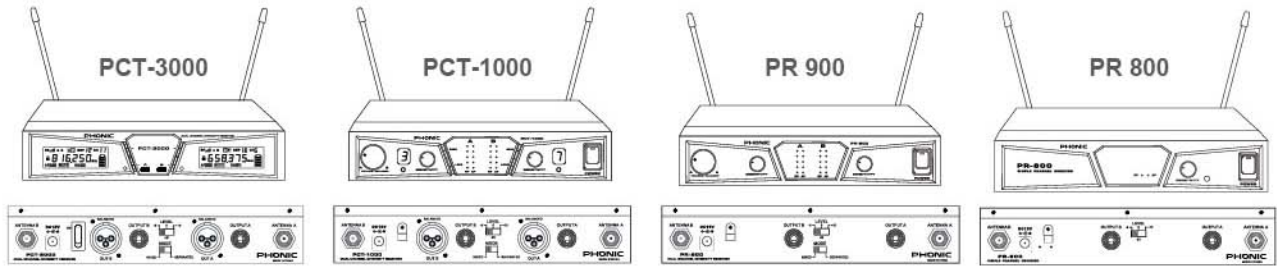

Preprogrammed Frequencies	29-Preset +1 User Defined Channel Groups w/ Autoscanner Technology	16-Preset Frequency Channels w/ Autoscanner Technology	Dual Channel Fixed Frequency	Single Channel Fixed Frequency
Carrier Frequency Range	500 to 875MHz (region dependent)	500 to 875MHz (region dependent)	500 to 875MHz (region dependent)	500 to 875MHz (region dependent)
Deviation	±50KHz, with level limiting	±50KHz, with level limiting	±56KHz, with level limiting	±56KHz, with level limiting
Max. Simultaneous Units	10 channels per group (48 mics total)	Up to 6 units (12 mics)	Up to 4 units (8 mics)	Up to 6 units (6 mics)
Operating Distance	Up to 70 meters / 230 feet	Up to 70 meters / 230 feet	Up to 60 meters / 200 feet	Up to 60 meters / 200 feet
Bandwidth	72 MHz	24 MHz	24 MHz	24 MHz
Stability	±0.005%	±0.005%	±0.005%	±0.005%
S/N Ratio	>106dB (A-weighted)	>106dB (A-weighted)	>106dB (A-weighted)	>106dB (A-weighted)
T.H.D.	<0.5% @ 1 kHz	<0.5% @ 1 kHz	<0.5% @ 1 kHz	<0.5% @ 1 kHz
Frequency Response	50Hz to 18KHz	50Hz to 18KHz	50Hz to 18KHz	50Hz to 18KHz
Sensitivity	S/N>76dB at 10 micro V	S/N>76dB at 10 micro V	S/N>76dB at 10 micro V	S/N>76dB at 10 micro V
Spurious Rejection	> 80dB	> 80dB	> 80dB	> 80dB
Output Connectors	¼" TRS and XLR (per channel)	¼" TRS and XLR (per channel)	¼" TRS (per channel)	¼" TRS
Output Level Switch	Selectable: +10dBV, 0dBV, -6dBV	Selectable: +10dBV, 0dBV, -6dBV	Selectable: +10dBV, 0dBV, -6dBV	Selectable: +10dBV, 0dBV, -6dBV
Power Supply	DC 15V, 0.8A	DC 15V, 0.8A	DC 15V, 0.6A	DC 15V, 0.6A
Dimensions (W x D x H)	218 × 192 × 44 mm (8.6" 7.6" x 1.7")	218 × 192 × 44 mm (8.6" 7.6" x 1.7")	218 × 192 × 44 mm (8.6" 7.6" x 1.7")	218 × 192 × 44 mm (8.6" 7.6" x 1.7")
Weight	1.8 kg (3.97 lbs)	1.8 kg (3.97 lbs)	1.7 kg (3.75 lbs)	1.2 kg (2.6 lbs)

Specifications

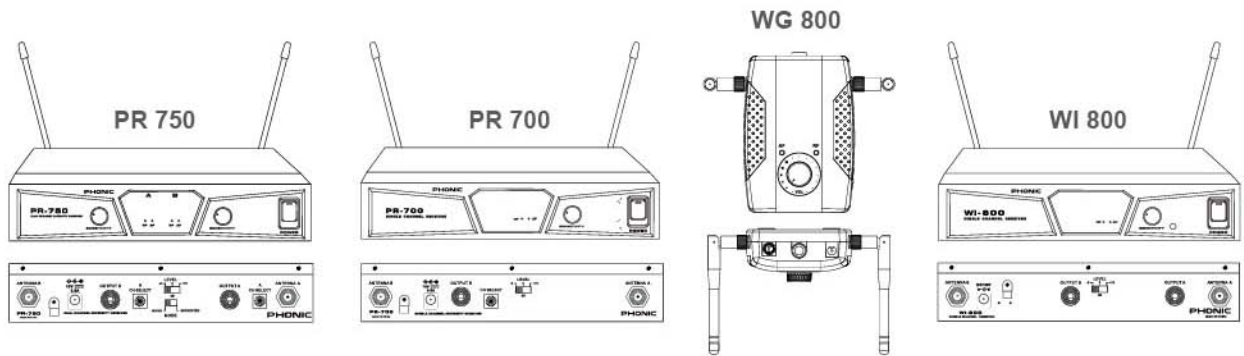

Preprogrammed Frequencies	Dual Channel Selectable Frequency	Single Channel Selectable Frequency	Single Channel Selectable Frequency	Single Channel Selectable Frequency
Carrier Frequency Range	500 to 875MHz (region dependent)	500 to 875MHz (region dependent)	500 to 875MHz (region dependent)	500 to 875MHz (region dependent)
Deviation	±56KHz, with level limiting	±56KHz, with level limiting	±56KHz, with level limiting	±56KHz, with level limiting
Max. Simultaneous Units	Up to 4 units (8 mics)	Up to 6 units (6 mics)	Up to 6 units (12 mics)	Up to 6 units (12 mics)
Operating Distance	Up to 60 meters / 200 feet	Up to 60 meters / 200 feet	Up to 60 meters / 200 feet	Up to 70 meters / 230 feet
Bandwidth	24 MHz	24 MHz	24 MHz	24 MHz
Stability	±0.005%	±0.005%	±0.005%	±0.005%
S/N Ratio	>106dB (A-weighted)	>106dB (A-weighted)	>106dB (A-weighted)	>106dB (A-weighted)
T.H.D.	<0.5% @ 1 kHz	<0.5% @ 1 kHz	<0.5% @ 1 kHz	<0.5% @ 1 kHz
Frequency Response	50Hz to 18KHz	50Hz to 18KHz	50Hz to 18KHz	50Hz to 18KHz
Sensitivity	S/N>76dB at 10 micro V	S/N>76dB at 10 micro V	S/N>76dB at 10 micro V	S/N>76dB at 10 micro V
Spurious Rejection	> 80dB	> 80dB	> 80dB	> 80dB
Output Connectors	¼" TRS (per channel)	¼" TRS	¼" TRS	¼" TRS
Output Level Switch	Selectable: +10dBV, 0dBV, -6dBV	Selectable: +10dBV, 0dBV, -6dBV	Selectable: +10dBV, 0dBV, -6dBV	Selectable: +10dBV, 0dBV, -6dBV
Power Supply	DC 15V, 0.6A	DC 15V, 0.6A	DC 15V, 0.8A	DC 15V, 0.8A
Dimensions (W x D x H)	218 × 192 × 44 mm (8.6" 7.6" x 1.7")	218 × 192 × 44 mm (8.6" 7.6" x 1.7")	218 × 192 × 44 mm (8.6" 7.6" x 1.7")	218 × 192 × 44 mm (8.6" 7.6" x 1.7")
Weight	1.2 kg (2.6 lbs)	1.2 kg (2.6 lbs)	1.2 kg (2.6 lbs)	1.2 kg (2.6 lbs)